

AR70S®

www.artos-westover.com

Installation Guide

In-Wall Lav Faucet, Extended Spout

F501-9-1

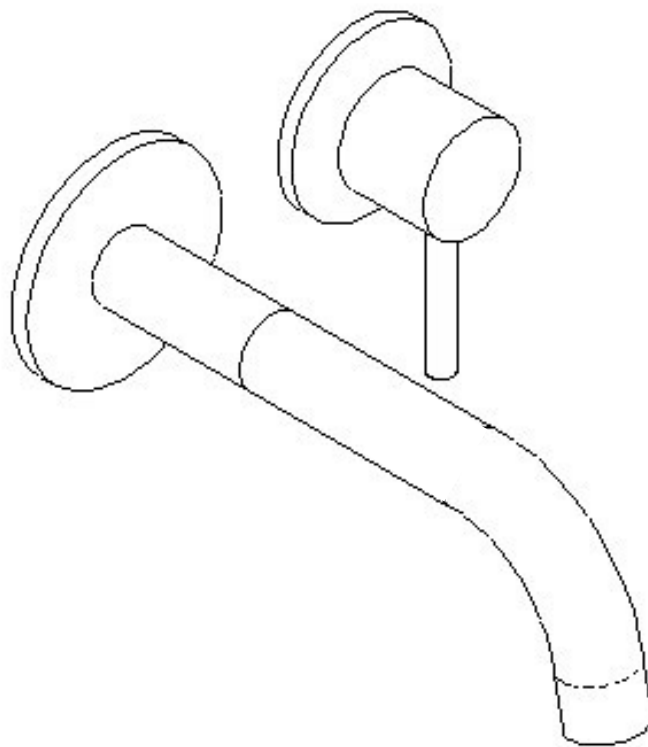

50180811

This publication is for illustrative purposes only and we reserve the right to change details at anytime as deemed necessary.

Fig A

DIMENSIONS

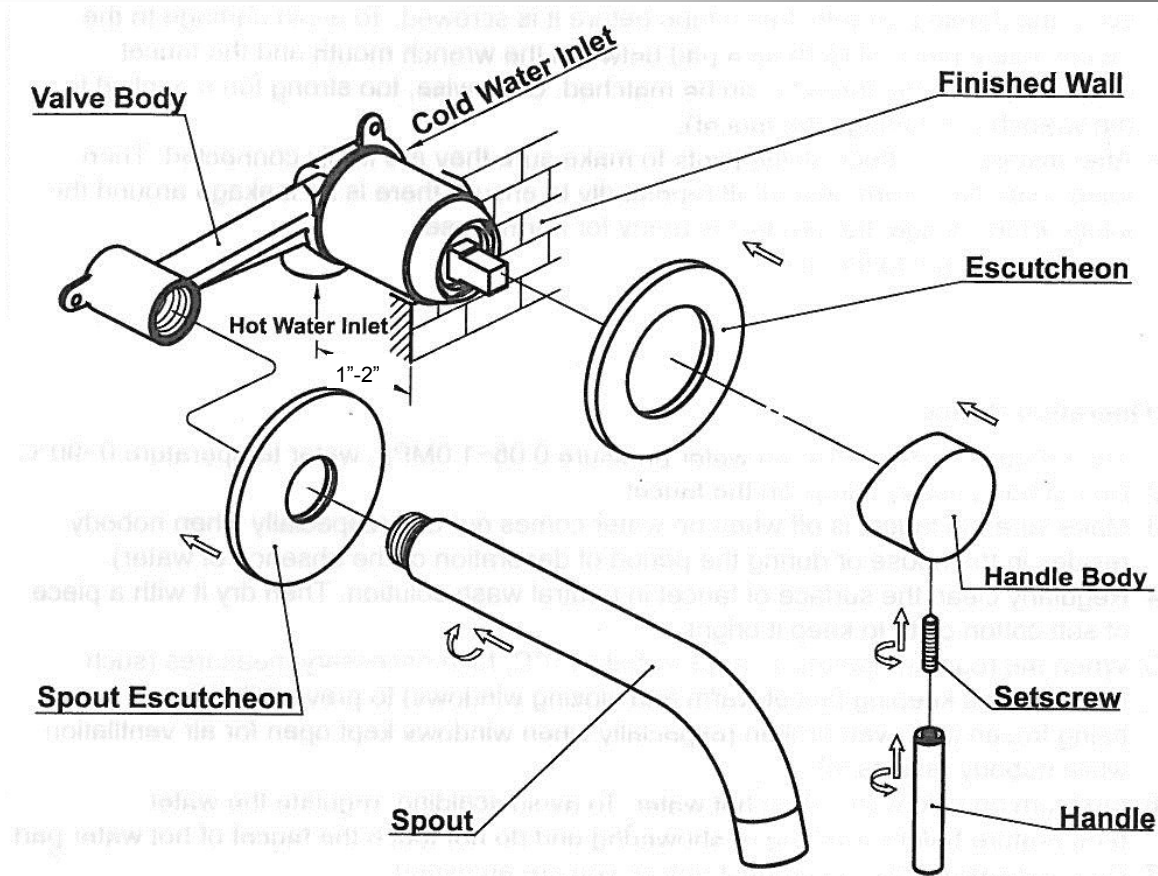

SPECIFICATIONS AND STANDARDS

- ☐ Recommended flow pressure between 15 and 75 psi. Above 90 psi it may be necessary to install a pressure reducer. Maximum operating temperature 176°F

APPROVALS:

- ☐ AB1953, NSF61 section 9 Certified.
- ☐ Complies with ADA Standards.

INSTALLATION STEPS

- ☐ Install the integrated rough with reference to the min and max markings on the mixer plaster guard in relation to the finished wall surface (a minimum of 1 " or maximum of 2 " from the center of the water inlet to the finished wall surface).
- ☐ Flush pipes and check for water tightness
- ☐ Provide a hole in the wall surface for the plaster guard and screw in the spout connection. Replace tub filler plaster guard

After Wall is Finished

- ☐ Push escutcheons up to finished wall surface
- ☐ Push the spout over the wall connection and secure with set screw
- ☐ Install handle in the correct orientation
- ☐ Check for correct operation

CARE & MAINTENANCE

For best results, keep the following in mind to retain the high quality finish of your *ARTOS* faucet:

- Use a soft, dampened sponge or cloth. On no account should you use an abrasive material such as a brush, scouring pad or steel wool to clean surfaces.
- Test your cleaning agent solution on an inconspicuous area before applying to the entire faucet.
- Wipe surfaces clean and rinse completely with water immediately after applying cleaning agent.
- An ideal cleaning technique is to rinse faucet thoroughly and blot dry any water from the surface after each use.

LIMITED LIFETIME WARRANTY

ARTOS faucets are guaranteed for life against leaks and finishing defects for as long as the original purchaser owns it.

Damage caused by accident, misuse, abuse, improper installation, improper cleaning or alteration will void the warranty. This warranty does not cover replacement parts where damage is caused by normal wear and tear. Westover, Inc is not responsible for labor charges, installation or other incidental or consequential costs. Proof of purchase must be provided with all claims.

PLEASE REGISTER THIS PRODUCT ONLINE AT WWW.ARTOS-WESTOVER.COM

Item No
Serial No

50180811